

15MPa B型銅管くい込継手 (150kgf/cm²)

GS-1

FEMAL CONNECTOR

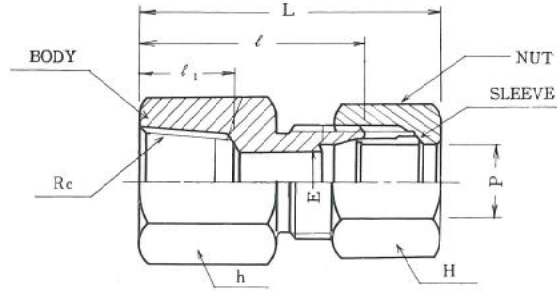
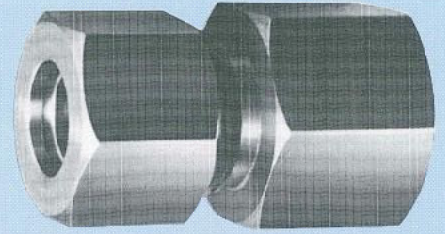

(注) L寸法はナットを締付け前の概略寸法を示す。

L denotes the rough dimensions before tightening the nuts. 単位: mm

継手の呼称 Designation of joints	各部の記号 Symbols of respective parts	適用する 管の外径 Tube(O.D) P	Minimum Opening E	六角対辺 Opposite sides of hexagon		l_1	l	(約) Approx L	Rc (PT)	1組分 Wt Weight per set (kg)
				h	H					
GS-1	4-Rc $\frac{1}{8}$ -B	4	2.5	14	12	10	21	29	$\frac{1}{8}$	0.026
GS-1	4-Rc $\frac{1}{4}$ -B	4	2.5	19	12	14	26	31	$\frac{1}{4}$	0.039
GS-1	6-Rc $\frac{1}{8}$ -B	6	4	14	14	10	25	34.5	$\frac{1}{8}$	0.033
GS-1	6-Rc $\frac{1}{4}$ -B	6	4	19	14	14	30	38.5	$\frac{1}{4}$	0.051
GS-1	6-Rc $\frac{3}{8}$ -B	6	4	23	14	15	32	39.5	$\frac{3}{8}$	0.063
GS-1	8-Rc $\frac{1}{8}$ -B	8	6	17	17	10	25	36	$\frac{1}{8}$	0.041
GS-1	8-Rc $\frac{1}{4}$ -B	8	6	19	17	14	30	41	$\frac{1}{4}$	0.059
GS-1	8-Rc $\frac{3}{8}$ -B	8	6	23	17	15	32	43	$\frac{3}{8}$	0.071
GS-1	10-Rc $\frac{1}{4}$ -B	10	6	19	19	14	30	42.5	$\frac{1}{4}$	0.066
GS-1	10-Rc $\frac{3}{8}$ -B	10	8	23	19	15	32	44.5	$\frac{3}{8}$	0.077
GS-1	12-Rc $\frac{3}{8}$ -B	12	10	23	21	15	32	44.5	$\frac{3}{8}$	0.083
GS-1	12-Rc $\frac{1}{2}$ -B	12	10	29	21	19	36	48.5	$\frac{1}{2}$	0.140
GS-1	14-Rc $\frac{3}{8}$ -B	14	10	23	26	15	34	46.5	$\frac{3}{8}$	0.116
GS-1	14-Rc $\frac{1}{2}$ -B	14	11	29	26	19	38	50.5	$\frac{1}{2}$	0.163
GS-1	15-Rc $\frac{3}{8}$ -B	15	12	23	26	15	34	46.5	$\frac{3}{8}$	0.117
GS-1	15-Rc $\frac{1}{2}$ -B	15	12	29	26	19	38	50.5	$\frac{1}{2}$	0.165
GS-1	16-Rc $\frac{1}{2}$ -B	16	13	29	29	19	38	51.5	$\frac{1}{2}$	0.183
GS-1	18-Rc $\frac{1}{2}$ -B	18	14	29	32	19	38	51.5	$\frac{1}{2}$	0.200
GS-1	18-Rc $\frac{3}{4}$ -B	18	15	35	32	21	41	54.5	$\frac{3}{4}$	0.240
GS-1	20-Rc $\frac{1}{2}$ -B	20	17	29	35	19	38	50.5	$\frac{1}{2}$	0.224
GS-1	20-Rc $\frac{3}{4}$ -B	20	17	35	35	21	41	53.5	$\frac{3}{4}$	0.264
GS-1	22-Rc $\frac{1}{2}$ -B	22	13	35	36	19	38	50.5	$\frac{1}{2}$	0.229
GS-1	22-Rc $\frac{3}{4}$ -B	22	18	35	36	21	41	53.5	$\frac{3}{4}$	0.267
GS-1	25-Rc $\frac{3}{4}$ -B	25	20	41	41	21	41	54.5	$\frac{3}{4}$	0.387
GS-1	25-Rc 1-B	25	20	41	41	24	45	58.5	1	0.417
GS-1	30-Rc 1-B	30	25	41	46	24	47	61.5	1	0.478