

15MPa B型銅管くい込継手  
(150kgf/cm<sup>2</sup>)

GT-2型

MALE BRANCH TEE

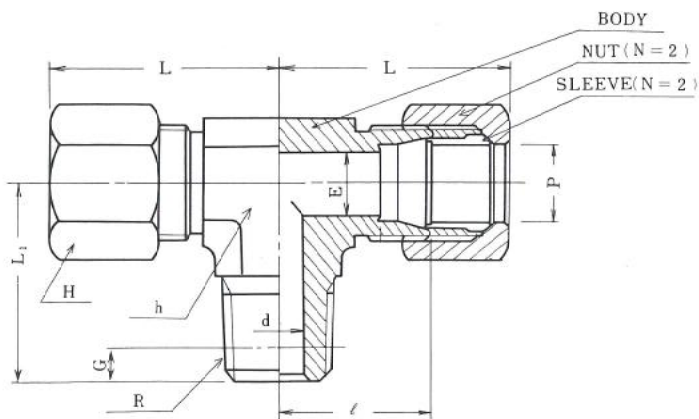

(注) L寸法はナットを締付け前の概略寸法を示す。

L denotes the rough dimensions before tightening the nuts.

単位：mm

継手の呼称 Designation of Joints	各部の名称 Symbols of respective parts	適用する 管の外径 Tube(O.D) P	Minimum Opening E	d	基準径 の位置 Position of refer- ence diameter G	二面巾 Width Across Flats h	六角対辺 Opposite sides of hexagon H	ℓ	(約) Approx L	(約) Approx L <sub>1</sub>	R (PT)	1組分 Wt Weight per set (kg)
GT-2	4-R <sup>1</sup> / <sub>8</sub> -B	4	2.5	4	3.97	12	12	15	23	17	<sup>1</sup> / <sub>8</sub>	0.039
GT-2	6-R <sup>1</sup> / <sub>8</sub> -B	6	4	4	3.97	14	14	20	29.5	18	<sup>1</sup> / <sub>8</sub>	0.062
GT-2	6-R <sup>1</sup> / <sub>4</sub> -B	6	4	6	6.01	14	14	20	29.5	22	<sup>1</sup> / <sub>4</sub>	0.069
GT-2	6-R <sup>3</sup> / <sub>8</sub> -B	6	4	8.5	6.35	19	14	23	34	28	<sup>3</sup> / <sub>8</sub>	0.110
GT-2	8-R <sup>1</sup> / <sub>8</sub> -B	8	6	4	3.97	17	17	22	33	20	<sup>1</sup> / <sub>8</sub>	0.096
GT-2	8-R <sup>1</sup> / <sub>4</sub> -B	8	6	6	6.01	17	17	22	33	25	<sup>1</sup> / <sub>4</sub>	0.101
GT-2	8-R <sup>3</sup> / <sub>8</sub> -B	8	6	8.5	6.35	19	17	23	35	28	<sup>3</sup> / <sub>8</sub>	0.120
GT-2	10-R <sup>1</sup> / <sub>4</sub> -B	10	8	6	6.01	17	19	23	34	25	<sup>1</sup> / <sub>4</sub>	0.112
GT-2	10-R <sup>3</sup> / <sub>8</sub> -B	10	8	8.5	6.35	19	19	23	34	28	<sup>3</sup> / <sub>8</sub>	0.131
GT-2	12-R <sup>1</sup> / <sub>4</sub> -B	12	10	6	6.01	19	21	24	36.5	27	<sup>1</sup> / <sub>4</sub>	0.135
GT-2	12-R <sup>3</sup> / <sub>8</sub> -B	12	10	8.5	6.35	19	21	24	36.5	28	<sup>3</sup> / <sub>8</sub>	0.144
GT-2	14-R <sup>3</sup> / <sub>8</sub> -B	14	11	8.5	6.35	23	26	29	41.5	33	<sup>3</sup> / <sub>8</sub>	0.231
GT-2	14-R <sup>1</sup> / <sub>2</sub> -B	14	11	12	8.16	23	26	29	41.5	35	<sup>1</sup> / <sub>2</sub>	0.248
GT-2	15-R <sup>3</sup> / <sub>8</sub> -B	15	12	8.5	6.35	23	26	29	41.5	33	<sup>3</sup> / <sub>8</sub>	0.238
GT-2	15-R <sup>1</sup> / <sub>2</sub> -B	15	12	12	8.16	23	26	29	41.5	35	<sup>1</sup> / <sub>2</sub>	0.253
GT-2	16-R <sup>1</sup> / <sub>2</sub> -B	16	13	12	8.16	23	29	29	41.5	35	<sup>1</sup> / <sub>2</sub>	0.287
GT-2	18-R <sup>1</sup> / <sub>2</sub> -B	18	15	12	8.16	29	32	33	45.5	38	<sup>1</sup> / <sub>2</sub>	0.405
GT-2	20-R <sup>3</sup> / <sub>4</sub> -B	20	17	17	9.53	29	35	33	45.5	41	<sup>3</sup> / <sub>4</sub>	0.446
GT-2	22-R <sup>3</sup> / <sub>4</sub> -B	22	18	17	9.53	29	36	34	47	41	<sup>3</sup> / <sub>4</sub>	0.453
GT-2	25-R 1-B	25	20	20	10.39	35	41	36	49.5	46	1	0.714